



## Safe Locks

For money, valuables, important documents or other sensitive items that need to be protected against unauthorized access: Choose from our unique safe lock portfolio for ATMs, gun safes, vaults, classified document storage units, fire-proof safes or other secure storage solutions. We offer full protection for your property with certified quality products.





## Safe Locks

How valuables are protected:  
with particularly secure locks.

Only consistent stability paired with intelligence can prevent unauthorized access to money, valuables, important documents or sensitive goods. That's why all of our safe locks have been specially developed for ATMs, weapon safes, strong rooms, classified document storage units or fireproof storage methods. We enhance the proven locking mechanisms with network-compatible electronics. Thanks to digitalization, user rights and blocking periods can be comprehensively controlled. Clear, controllable and certified.



#### Electronic safe locks

Digitally enhanced mechanics, suitable for the desired level of security for complex assignments.



#### Mechanical safe locks

Double-bit keys or number combinations up to and including resistance class C are available.



#### Electronically controllable key locks

Patented electromechanics for externally controlled processes with up to ten million different combinations.



#### Safe deposit box locks

Bank and renter lock, single-bit or double-bit key, purely mechanical or electronic.

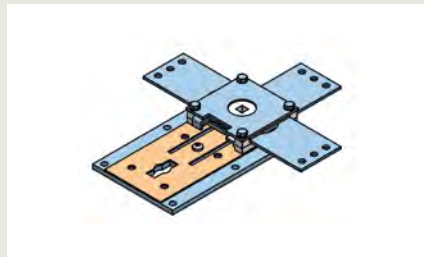

#### Bolt work

Patented security features for secure storage units in resistance classes 0–VII.



#### Other safe components and accessories

Safe door hinges, tamper protection, operating elements, handles, key rosettes and dial & ring combinations.



For more information, see here:  
[www.dormakaba.com](http://www.dormakaba.com)

# Electronic safe locks

## MAUER series



### MAUER Combi B 30

Electronic combination lock with dead bolt and mechanical redundancy. Particularly suitable for secure storage units in classes CEN III–V.

The Combi B 30 is the successor to the popular Code Combi B.

In addition to a completely redesigned and more user-friendly fitting design, the lock also offers a significantly broader range of functions. The integrated mechanical redundancy guarantees the highest level of operational security: By simply removing the rotary handle, the concealed keyhole is exposed and the lock can be opened with the double-bit key.

Software with which the lock's event memory can be read or all programming processes easily carried out is also available.



### MAUER Code-Combi K

Electronic combination lock with dead bolt for secure storage units in classes CEN 0–II with approx. 1,000,000 possible combinations.

The user can program a maximum of two six-digit codes. By using the power-saving magnet hold-open technology, approx. 30,000 opening cycles can be activated with one battery, under selected operating conditions.

A three-sided lock is also available, if required.



# LA GARD series



## **LA GARD AuditGard 66E**

In addition to its basic functions, the AuditGard series offers extensive user and audit functions. Customer-specific settings must be programmed using PC software. The optional eKey function enables an opening that, in addition to the opening code, also needs the copy-protected eKey. Various metal input units are available with non-slip silicone or sturdy membrane keypad.



## **LA GARD ComboGard Pro 39E**

As a further development of the ComboGard series, the Pro version offers customer-specific function programming using an input unit or PC setup software. Various metal input units are available with non-slip silicone or sturdy membrane keypad.



## **LA GARD Basic**

The Basic series has basic functions which enable very user-friendly operation. Various metal input units are available with non-slip silicone or sturdy membrane keypad.

Depending on the safe design, the lock systems can be supplied with either a dead bolt or a swing bolt. With the patented, spindle-less swivel bolt technology, the bolt is pushed back by actuating the bolt work. A separate, manual bolt opening is therefore not necessary.

# Mechanical safe locks

## MAUER series

Our double-bit locking technology for safe locks benefits from established, reliable technology. It has proved its worth particularly for secure storage units of all types up to resistance class X.



### MAUER Primus C

Safe lock with up to 13,000,000,000 possible combinations



### MAUER Varos

Adaptable safe lock with "mini-bit" round key



### MAUER Variator B

Adaptable safe lock with approx. 60,000,000 possible combinations



### MAUER Variator A

Adaptable safe lock with approx. 280,000 possible combinations



### MAUER Convar B

Adaptable safe lock with optional three-sided lock



### MAUER President A

Adaptable safe lock with approx. 280,000 possible combinations



### MAUER Curator 80

Lock, prepared for profile cylinder



### MAUER Tricontus A

Safe lock in three-pin design



### MAUER Vary Flex

Adaptable safe lock with approx. 78,000 possible combinations and further options



### MAUER Centurio A

Safe lock with flat bolt and vertical bascule lock



### MAUER Arator

Very compact safe lock with approx. 280,000 possible combinations



### MAUER Novum TD

Mechanical delayed opening safe lock with latch bolt

# LA GARD series

If you prefer the traditional, tried-and-tested disc wheel technology, we recommend our mechanical combination locks. The area of application for this product group is secure storage units of all types up to resistance class V.



## **LA GARD 2270**

Adaptable safe lock with approx. 160,000 possible combinations



## **LA GARD 1985**

Adjustable three-disc combination lock for secure storage units in classes CEN III–V



## **LA GARD 3390V**

Adjustable three-disc combination lock for secure storage units in classes CEN III–V



## **LA GARD 3390S**

Adjustable three-disc combination lock for secure storage units in classes CEN I–II



## **LA GARD 1947**

Adjustable four-disc combination lock for secure storage units in classes CEN VI–X



# Electronically controllable key locks

## MAUER series

The mechatronic double-bit locking systems are mainly used in customer-specific control units, where, with their patented lock and unlock functions, they can be easily integrated.



For more information, see here: [www.dormakaba.com](http://www.dormakaba.com)



### **MAUER Varios E Flex**

Adaptable, electronically controlled safe lock with approx. 390,000 possible combinations and further options



### **MAUER Variator B**

Adaptable, electronically controlled safe lock with approx. 10,000,000 possible combinations

# Safe deposit box locks

## MAUER series

The safe deposit box locks are mainly used for rented bank safe deposit box systems. We offer a variety of solutions that can be integrated into various security concepts.



**MAUER Deposit 20**  
Safe deposit box lock with bank and renter lock with two keyholes



**MAUER Combi Deposit**  
Semi-adaptable safe deposit box lock with combination lock and key lock box



**MAUER Deposit 10**  
Safe deposit box lock with bank and renter lock with one keyhole



**MAUER Deposit**  
Safe deposit box lock with electronic bank lock



**MAUER E-lo-safe M**  
Semi-adaptable safe deposit box lock with bank lock and renter lock



**MAUER E-lo-safe S**  
Electronically controllable safe deposit box lock with double bit technology



**MAUER Deposit E**  
Mailbox lock with flat bolt and one-touch key



**MAUER E-lo-safe D**  
Electronically controlled safe deposit box lock with rotary knob



**MAUER Deposit D**  
Mailbox lock with flat bolt and double-bit key



**MAUER E-lo-safe C**  
Electronically controllable safe deposit box lock with cylinder lock

# Bolt work



## MAUER series

The special feature of our popular bolt work solutions is their patented security features. They are installed in secure storage units in resistance classes 0–VII. Tell us what you need – we'll find it.



### MAUER Defender 520

The four-sided bolt mechanism is characterized by a smooth-running gear wheel drive.



### MAUER Defender 720

One to three-sided lock for secure storage units in classes CEN II–V

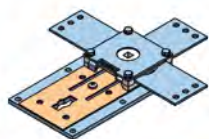

### MAUER Defender M3

Three-sided lock for secure storage units with smooth-running gear wheel drive. The bolt work has an integrated relocker and a manganese steel drill protection plate



### MAUER Defender 210

The four-sided bolt mechanism is characterized by a smooth-running gear wheel drive.



### MAUER Defender modules

The four-sided bolt work family is characterized by its patented modular system. The Defender Module 1 is designed in one-lock mode for cabinets in classes CEN 0–II.

# Other safe components and accessories

## MAUER series

In addition to the safe locks, dormakaba offers a comprehensive range of security cabinet components and security cabinet accessories.



**MAUER Relino 181**  
Heavy-duty, height-adjustable safe door hinge with axial and radial spherical bearings



**MAUER Relino 131 A**  
Safe door hinge with cable lead through for plane/docked installation applications



**MAUER Relino 71**  
Standard safe door hinge



**MAUER Relino 131 K**  
High-quality safe door hinge with maintenance-free bearing bushes



**MAUER Arvant R**  
Filling device set as tamper protection for a key lock



**MAUER Servant R**  
Operating element and tamper protection of the 70011 Primus C



**MAUER Servant K**  
Operating element and tamper protection of a key lock



**MAUER Vecto**  
Key guide for standard key

# Handles and key rosettes

## MAUER series

Our range of fittings and locks is rounded off by our selection of handles. Opt for the high-quality aluminum handle solutions in timeless designs or choose from our line of plastic designs. As functional and design elements, escutcheons complement safe doors and are suitable for use with mechanical double-bit locks.



**MAUER Vesta 145**  
Chrome-plated die-cast handle,  
145 mm



**MAUER Juno 115**  
Polished aluminum handle, 115 mm



**MAUER Talos 210**  
Polished aluminum handle, 210 mm



**MAUER Ceres 163**  
Polished aluminum handle, 163 mm



**MAUER Univers**  
Two-tone handle in high-quality  
plastic



**Elos 125**  
Chrome-plated die-cast handle,  
125 mm



**Pallas**  
Black coated die-cast handle,  
diameter 100 mm



**Ilos**  
Polished aluminum handle, diameter  
156 mm



**Alea K**  
Polished aluminum fold-down handle  
with finger grip, diameter 97 mm



**MAUER Stega 50**  
Polished aluminum rosette,  
diameter 50 mm



**MAUER Stega 63**  
Polished aluminum rosette,  
diameter 63 mm



**MAUER Stega Univers**  
Two-color rosette with adjustable  
key guide made of high-quality  
plastic



# Dial & ring combinations

## MAUER series and LA GARD series

Our dial & ring combinations are made of high-quality shell-cast aluminum or die-cast zinc. They are used to operate mechanical combination locks.



### **MAUER Depravo K**

Dial & ring combination in polished aluminum, top reading, diameter 88 mm



### **LA GARD 2107**

Conical dial & ring combination, diameter 76 mm



### **LA GARD 1777-1779**

Conical dial & ring combination, diameter 95 mm (can be locked if required)



### **LA GARD 1730-1731**

Conical dial & ring combination, top reading, diameter 74 mm (can be locked if required)



### **LA GARD 2085-2090**

Conical dial & ring combination, top reading, diameter 96 mm, (can be locked if required)