



AR8182 & AR9292



ARRONE® 2 ball bearing stainless steel Grade 13 radius corner butt hinge:

- Dimensions: 102x76x3mm
- Sold as a pair
- Suitable for doors weighing up to 120kg (Grade 13)
- Supplied with 16 x 201 grade stainless steel pozi countersunk wood screws
- Successfully type tested for conformity to all the requirements of **BS EN1935: 2002 Grade 13**

4	7	6	1*	1	4	0	13
---	---	---	----	---	---	---	----

- CE Marked: Certificate 1121-CPD-AC0070
- CPR Declaration of Performance: HUK0021
- Certifire approved: Certificate CF369
- Intumescent pack available separately for use on timber fire doors (AR/INT-8180/8580)

Product ref.	Article description	Finish	Article no.
AR8182-SSS	Radius corner butt hinge	SSS	87105952
AR9292-PSS	Radius corner butt hinge	PSS	87105953

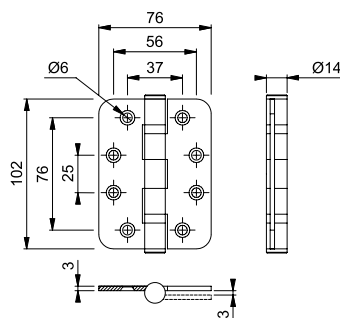

Included in a successful fire test to BS EN1634 Part-1. Suitable for use on 30, 60, 90 and 120 minute timber (Intumescent pack must be used) and 240 minute steel fire doors

AR8184



ARRONE® 2 ball bearing stainless steel Grade 13 square corner butt hinge:

- Dimensions: 102x102x3mm
- Sold as a pair
- Suitable for doors weighing up to 120kg (Grade 13)
- Supplied with 16 x 201 grade stainless steel pozi countersunk wood screws
- Successfully type tested for conformity to all the requirements of **BS EN1935: 2002 Grade 13**

4	7	6	1*	1	4	0	13
---	---	---	----	---	---	---	----

- CE Marked: Certificate 1121-CPD-AC0070
- CPR Declaration of Performance: HUK0017
- Certifire approved: Certificate CF369
- Intumescent pack available separately for use on timber fire doors (AR/INT-8184)

Product ref.	Article description	Finish	Article no.
AR8184-SSS	Square corner butt hinge	SSS	87105949

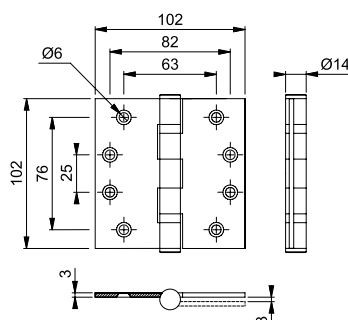

Included in a successful fire test to BS EN1634 Part-1. Suitable for use on 60 minute timber fire doors (Intumescent pack must be used)

ARRONE® Intumescent Packs

ARRONE® intumescent Pack:

- Intumescent pack to suit ARRONE® hinges
- 1mm thickness
- Pack of 6 (to suit 1½ pairs)



Product ref.	Article description	Article no.
AR/INT-8180/8580	To suit 102 x 76mm sized hinges	50004578
AR/INT-8680/8380/8780	To suit 102 x 89mm sized hinges	50004585
AR/INT-8184	To suit 102 x 102mm sized hinges	50004591

