

GENERAL CATALOGUE



FOR RELEASES & ACCESS CONTROL SYSTEMS
ELECTROMAGNETS FOR
CLOSERS

OPENERS & CLOSERS[®] solutions
GENERAL CATALOGUE

WHO WE ARE

FAMILY AND INTERNATIONAL SPIRIT

From our beginnings in 1989, where we only had a map and a lot of enthusiasm for entrepreneurship, we started our international adventure by manufacturing our first electric strike for the UK.

In a tour garage in Barcelona, we designed and manufactured the Series 2 in an artisan way to gradually distribute it throughout Europe. Over the years, we moved to a 2.000 m2 facility and incorporated more electric strike models to meet the needs of the market and our customers.

With 10 years of experience in the international market, we landed in Spain in the year 2000 with great enthusiasm. The beginnings was difficult because OPENERS & CLOSERS as a brand was unknown at a national level and there was also a strong competition in the sector, but we never gave up, and with a lot of energy and perseverance we continue to move forward until today.

In 2016 we moved the OPENERS & CLOSERS headquarters again to increase our production capacity. We completely refurbished an industrial building located in Sant Feliu de Llobregat, which offered the ideal space to equip it with the latest technologies and continue with our innovative spirit.

Who would have thought that over the next 5 years we would be working non-stop to create new door locking solutions and meet the growing demand for more technological and sustainable products. Also, like everyone else, we had to overcome the global pandemic of 2020.

We're very proud of the path we've been walking these last 33 years, but nothing would have been possible without the efforts of the people who make up OPENERS & CLOSERS and the ongoing trust of our clients. Without them, our passion for creating door locking mechanisms and access control systems that make life easier in wouldn't have been possible.

We want to keep growing with you.

CATALOGO 2022
INCONTRI ELETTRICI - SERRATURE ELETTRICHE - ACCESSORI

The power of an idea



OUR SOLUTIONS

VISION, DESIGN AND ENTHUSIASM TO CREATE

The design of each electro-mechanism starts with a sketch.

OPENERS & CLOSERS has a rich history of manufacturing high quality strikes and locks that are relevant for today and designed to endure.

At our headquarters in Barcelona, the design and innovation department creates cutting-edge prototypes for tomorrow with the latest state-of-the-art machinery.

The in-house laboratory subjects our solutions to a rigorous quality process, homologating the strikes and locks in accordance with European standards to ensure optimal performance.

Our objective is to guarantee the safety and security of people improving convenience and comfort in their daily lives.

Narrow profiles

A compact electric strike that is only 16 mm wide. Ideal to install in doors with narrow wood, aluminium or PVC frames.



Models Series 5

These models are favourite for their small size and installation versatility.

Our designers have renewed the latch to improve its adjustment to 3 mm, and have created a model with IP68 waterproof protection of its electronic components.

The functionality of both the automatic and monitored systems has been reimagined to provide better contact and make its size as small as possible.

Fail-secure/
Fail-safe

4.500N

Fire
Ei 90
8.000N

Waterproof
IP68
4.500N

Basic



5



5F



5W

Universal

9-24V y 22-28 AC/DC
AC < 1 min

Side load:
200N en AC
50N en DC



5U



5UF



5UW

Electronic

6-28V AC/DC 100%

Side load:
500N a 12-28V AC/DC



5E



5EF



5EW



Internal radian

The new radial system allows the keeper to rotate on its own axis. When the rotation is performed inside the mechanism of the box, the installation of the strike becomes easier, less time consuming and the mechanism is more aesthetically pleasing.



Hold-open system

Designers and engineers at O&C took the challenge to create a hold-open system that would be durable and also able to adapt to all kinds of door latches. The new hold open system is more reliable, simple and effective.

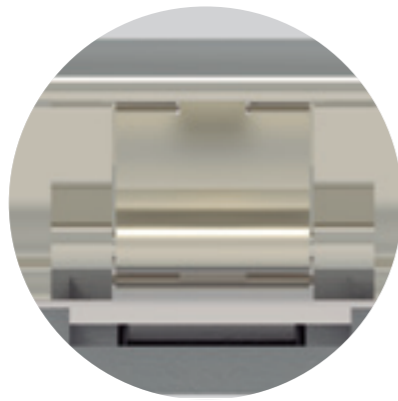

Unlocking lever

Our passion for every little detail made us enhance the traditional mechanical unlocking system of an electric strike. Now it's much more precise and durable.

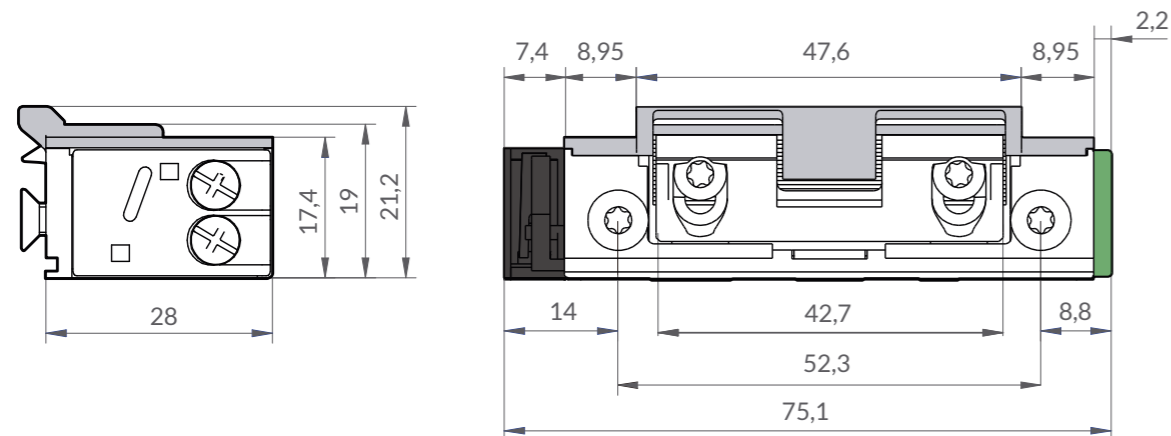
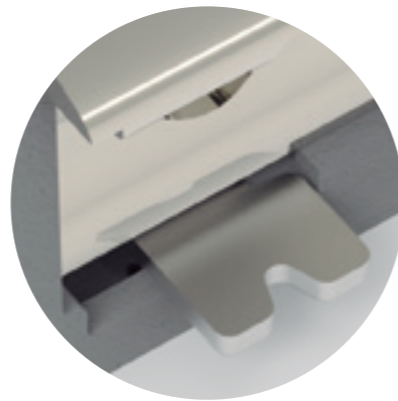

Models

5 5F 5W 5U 5UF 5UW 5E 5EF 5EW

Functions

0 1 2 3 4 6 8

Fail-secure | Fail-secure with mechanical unlocking | Fail-secure hold-open | Fail-secure hold-open with mechanical unlocking | Fail-safe | Fail-secure with monitoring | Fail-safe with monitoring

Coils

	B	T (Timer)	X	Y	Z
Electrical information	6 -14V AC/DC	12 V DC	9-24V AC/DC	22-28V AC/DC	6-28V AC/DC
Continuous duty AC	<1 min	-	<1 min	<1 min	ED 100%
Continuous duty DC	<1 min	<1 min	12V ED 100%	24V ED 100%	ED 100%
Transient Voltage Suppressor (TVS)	Yes	Yes	Yes	Yes	Yes
Rated resistance	8,5 Ω	42 Ω	43 Ω	200 Ω	8,5 Ω
Current consumption AC (start)	0,50 A . 6V 1 A12V 1,16 A 14V	-	0,15 A ... 9V 0,20 A12V 0,39 A .. 24V	0,08 A . 22V 0,08 A....24V 0,10 A ... 28V	0,22 A ...6V 0,36 A....12V 0,31 A 24V 0,29 A 28V
Current consumption AC (maintenance)	-	-	-	-	0,18 A6V 0,03 A....12V 0,02 A 24V 0,01 A 28V
Current consumption DC (start)	-	0,60 A . 12V	-	-	0,26 A ...6V 0,38 A....12V 0,34 A 24V 0,34 A 28V
Current consumption DC (maintenance)	0,71 A ... 6V 1,41 A 12V 1,65 A 14V	0,30 A . 12V	0,21 A ... 9V 0,28 A .. 12V 0,56 A .. 24V	0,11 A 22V 0,12 A ... 24V 0,14 A ... 28V	0,20 A ...6V 0,04 A....12V 0,02 A 24V 0,01 A 28V
Maximum side-load on AC	12V - 120 N	-	24V - 200N	28V - 200 N	12-28V - 500 N
Maximum side-load on DC (stabilized)	12V - 10 N	10 N	12V - 50 N	24V - 50 N	12-28V - 500 N

Internal Radian 1 2 0 1 2

Keepers

Keeper's depth	6 mm	6 mm	8 mm	6 mm	6 mm
Keeper's adjustability	2 mm	2 mm	-	2 mm	2 mm

Cover

0 1 1

Types of covers: Standard cover | Cover with latch guide | Cover with latch guide

Curved design

The mechanism box is curved for easy access to the multipoint locks.

The separation between the strike and the first bolt is only 5 mm.



Models Series 9

A strike designed to be integrated in multipoint lock doors and provide easy automatic access.

A resistant and asymmetrical mechanism with a curved box end so it can fit multipoint locks.

These models are used with Italian security locks and the latch's dimensions have been reduced for better adaptability.

Fail-secure/
Fail-safe

4.000N

Basic



9L/9R



Small keeper

The latch's size has been reduced to make it more adaptable and to gain more resistance.

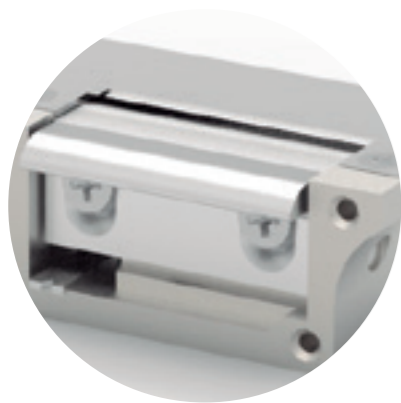

Hold-open system

The hold open system has been incorporated in the strikes exterior to offer new functionalities.

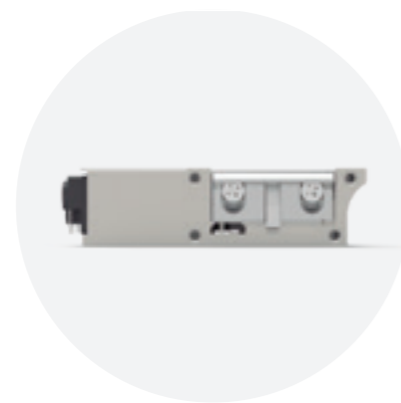

Multipoint

The end of the box is curved so the separation between the lock and the first bolt is only 5 mm.

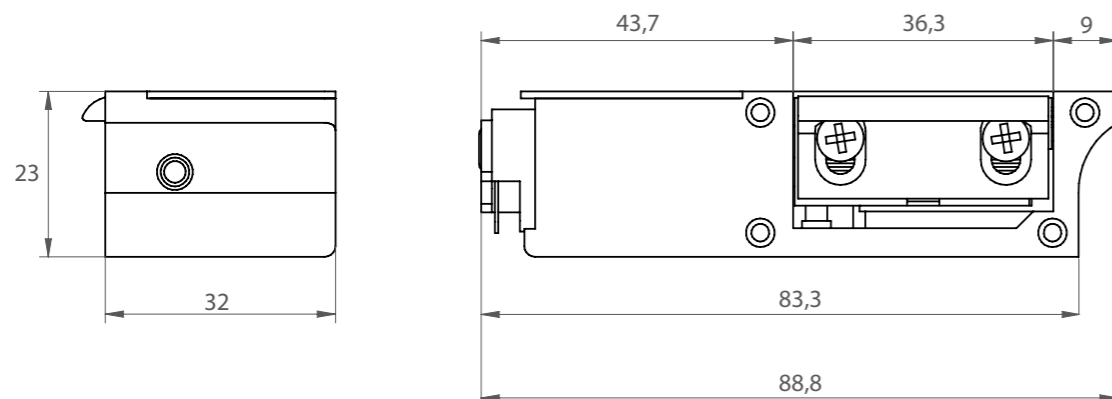

Models

9L/9R

Functions

0	1	2	3	4	A	B
Fail-secure	Fail-secure with mechanical unlocking	Fail-secure hold-open	Fail-secure hold-open with mechanical unlocking	Fail-safe	Fail-secure internal hold-open with mechanical unlocking	Fail-secure internal hold-open

Coils

	L	M	N
Electrical information	8-14 V AC/DC	12V DC	24V DC
Continuous duty AC	< 1 min	-	-
Continuous duty DC	< 1 min	ED 100%	ED 100%
Transient Voltage Suppressor (TVS)	-	Yes	Yes
Rated resistance	20 Ω	70 Ω	240 Ω
Current consumption AC (start)	0,28 A .. 8V 0,42 A ...12V 0,49 A .. 14V	-	-
Current consumption AC (maintenance)	-	-	-
Current consumption DC (start)	-	-	-
Current consumption DC (maintenance)	0,40 A .. 8V 0,60 A .. 12V 0,70 A .. 14V	0,17 A ... 12V	0,10 A ... 24V
Maximum side-load on AC	12V - 120 N	-	-
Maximum side-load on DC (stabilized)	12V - 10 N	12V - 10 N	24V - 10 N



External Radial

Keepers

Keeper's depth	9,3 mm
Keeper's adjustability	4 mm



Cover

Types of covers	Standard cover
-----------------	----------------

Faceplates

	L60X	L70X
Special faceplates for 3 and 4 bolt multipoint locks	Reversible 247x35x3	Reversible 247x35x3

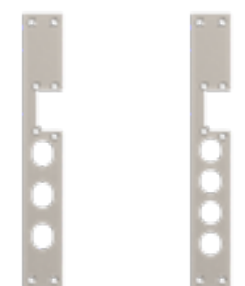

Standar
depth
3 mm

110 mm

130 mm

160 mm

22 mm



Rev.
S03X

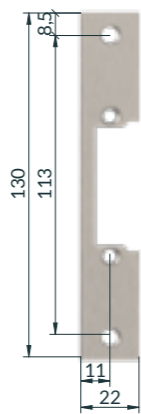

Rev.
S04X

Rev.
S05X

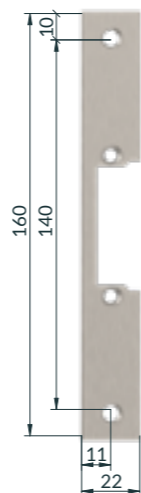

Rev.
S06X

Rev.
S07X

110 mm

130 mm

160 mm

24 mm

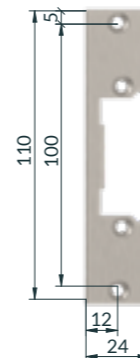

Rev.
S08X

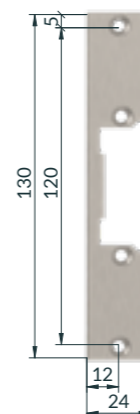

Rev.
S09X

Rev.
S10X

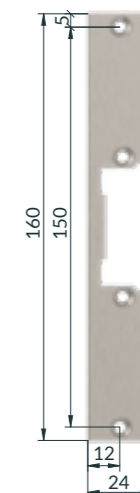

Rev.
S11X

Rev.
S12X

250 mm

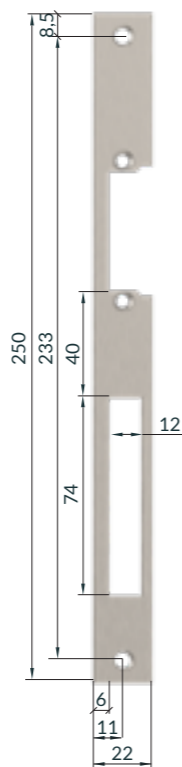

Rev.
L29X

Rev.
L30X

227,5 and 244 mm

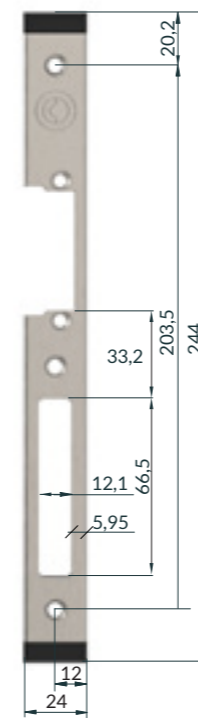

DIN R
L22X

Thick
6 mm

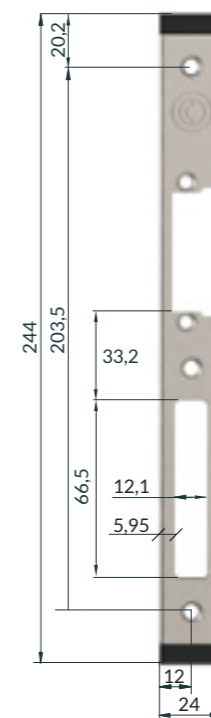

DIN L
L23X

Thick
6 mm

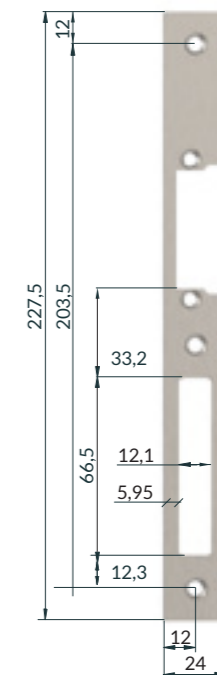

Rev.
L26X

Rev.
L27X

110 mm

130 mm

160 mm

110 mm

130 mm

160 mm

25 mm OPEN

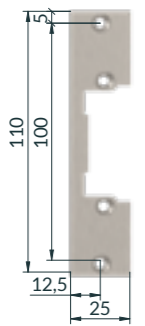

Rev. S13X

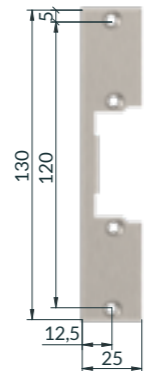

Rev. S14X

Rev. S15X

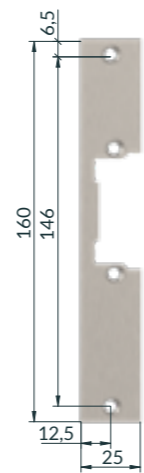

Rev. S16X

Rev. S17X

25 mm CLOSED Series 5

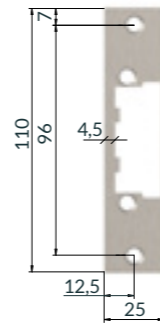

Rev. S18X

Rev. S19X

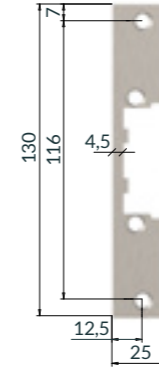

Rev. S20X

Rev. S21X

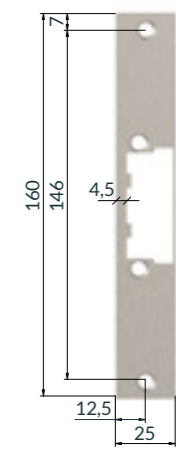

Rev. S22X

Rev. S23X

250 mm

250 mm

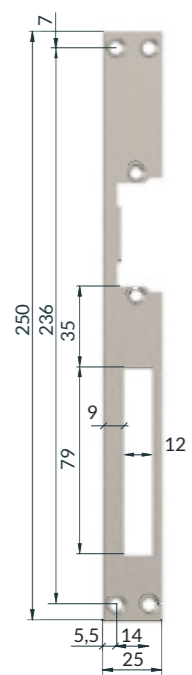

Rev. L03X

Rev. L06X

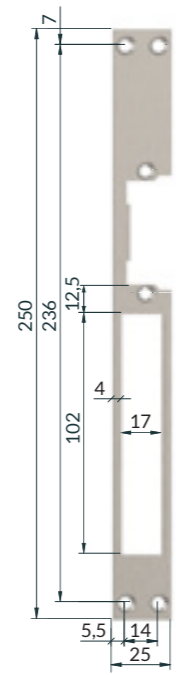

Rev. L04X

Rev. L08X

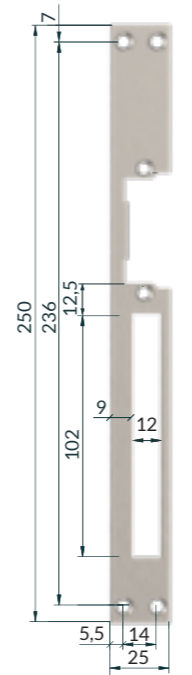

Rev. L05X

Rev. L10X

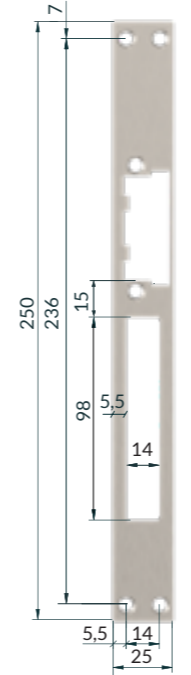

Rev. F20X

Rev. F21X

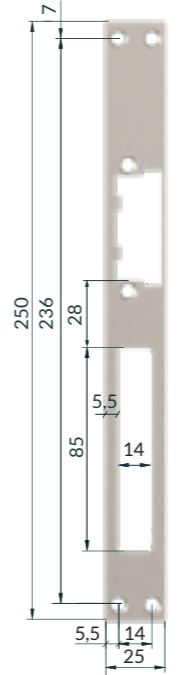

Rev. F22X

Rev. F23X

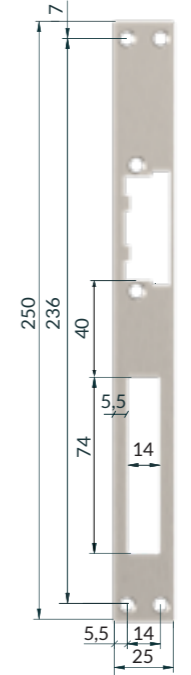

Rev. F24X

Rev. F25X

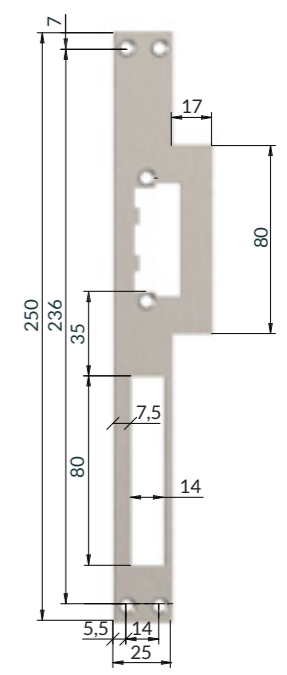

Rev. L38X

Rev. L39X

Special Series 9

247 mm

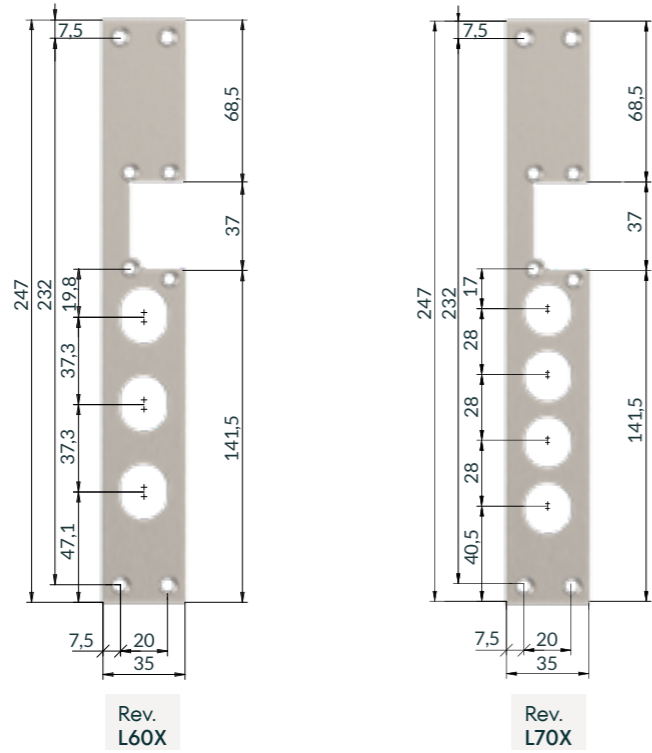

Angled

172 mm

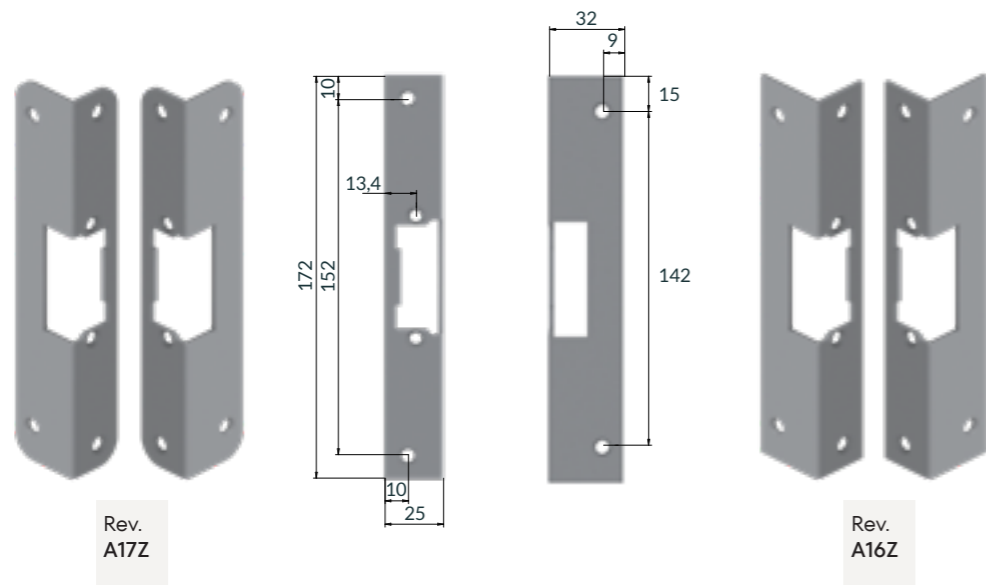

250 mm

DIN R A12Z



DIN L A13Z

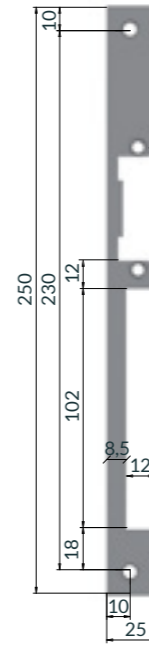

DIN R A08Z

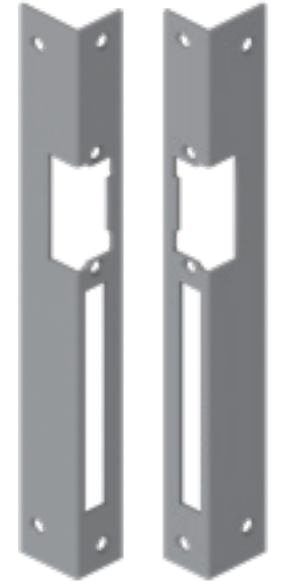

DIN L A09Z



DIN R A14Z



DIN L A15Z

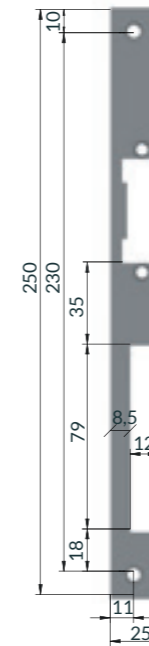

DIN R A10Z

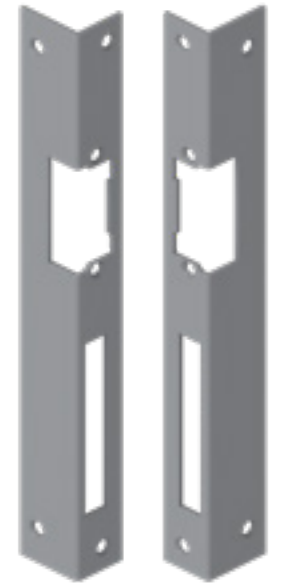

DIN L A11Z



DIN R A49X



DIN L A50X

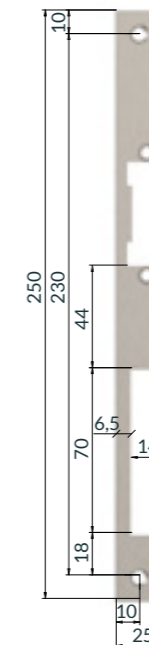

DIN R A51X

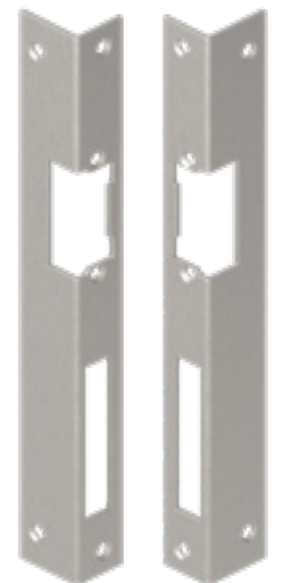

DIN L A52X





Electromagnetic locks

Total attraction

The solenoid generates a high-power electromagnetic field to lock the door.

Holding forces vary from 500 N to more than 5.000 N

Series M models

In OPENERS & CLOSERS characteristic brown, the Series M has anti-vandalism protection.

Our narrow european models have a more aesthetically pleasing installation and can be used with the new "E" complement.

Ecomax models are characterized by the lowest power consumption in the market with only 3W.

ME
Narrow profile 30mm
Surface mounted Embedded

MEX
ECOMAX
Surface mounted 

50 daN
130 lbf
Holding force

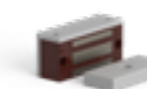

MEX50S
37x80x25

150 daN
330 lbf
Holding force

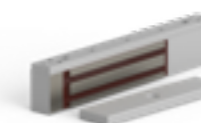

MEX150S
35x165,8x21 without attribute
40x223,8x22

280 daN
600 lbf
Holding force

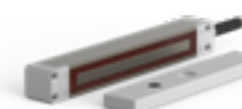

ME280S  IP65
30x228x31

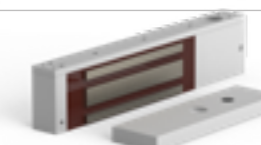

MEX280S
47x208x27,5 without attribute
47x241x27,5

300 daN
700 lbf
Holding force

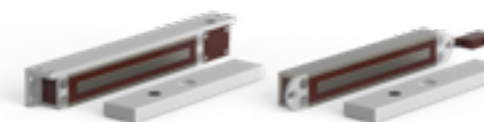

ME300S **ME300E**
35x265x31 30x202x26

350 daN
800 lbf
Holding force

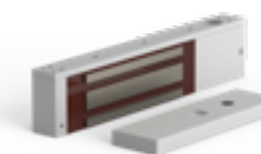

MEX350S
47x238x24 without attribute
47x271x27,5

500 daN
1.200 lbf
Holding force

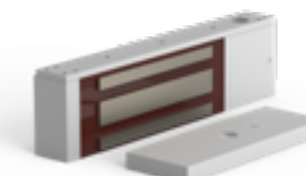

MEX500S
65x231x37 without attribute
65x264x37



Electromechanical locks



Accessories

Series DDC models

Their function is to take the electric current to the door's leaf only when it's closed.

DDC1 models include two nickel coated brass contacts while DDC2 models have a silver coating for better conductivity.

The interior of our electric contacts has been redesigned for an easier connection installation.

Interrupted current flow

For situations where the electromechanical lock only requires a single electrical pulse for its activation.

Minimum intensity current is 1,5 A.

Compatible with fail-secure locks.

Constant current flow

For situations where the electromechanic lock might require a constant current flow for its activation.

Minimum intensity current is 0,5 A.

Compatible with fail-secure and fail-safe locks.



DDC

Fail-secure functionality
24V AC/DC <1min

Fail-secure and fail-safe functionality
24V AC/DC <1min

Two contacts



DDC1K/DDC1W
70x13x11



DDC2K/DDC2W
86x20x22

Three contacts



DDC3K/DDC3W
86x20x22

Four contacts



DDC4K/DDC4W
86x20x22